

# Ø25 Cam

<b>1</b> CAMS AND COVERS.....		<i>pp.</i> ..... 254
<b>2</b> BOLTS.....		..... 255
<b>3</b> NUTS .....		..... 256

## 1 CAMS AND COVERS

### COVER Ø25 MM.

			
WHITE	RAL 9003	530.400.006	
BROWN	RAL 8016	530.400.010	2.000
BLACK	RAL 9005	530.400.021	
NICKEL-PLATED		530.400.065	1.000

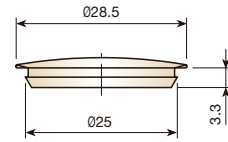

### COVER WITH LUGS Ø25 MM.

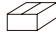
			
WHITE	RAL 9003	530.100.001	
BROWN	RAL 8016	530.100.012	2.000
BLACK	RAL 9005	530.100.023	

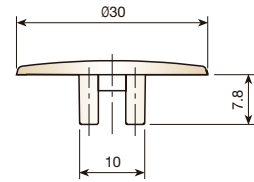

### CAM Ø25 MM.

			
NATURAL		510.011.106	2.000

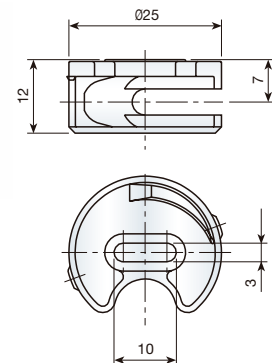

## 2 BOLTS

### WOOD THREADED BOLT.

DRILLING DISTANCE 33MM.



ZINC-COATED 520.839.034 2.000

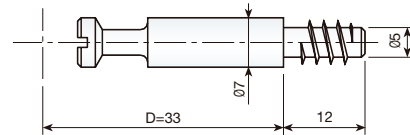
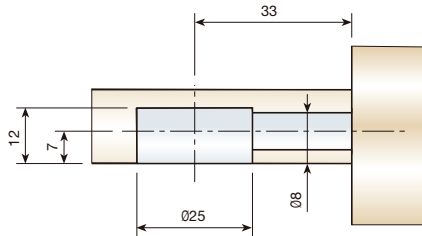

### BOLT M6.

DRILLING DISTANCE 33MM.



ZINC-COATED 520.735.036 2.000

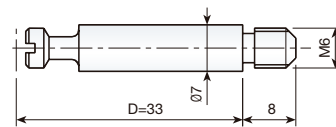
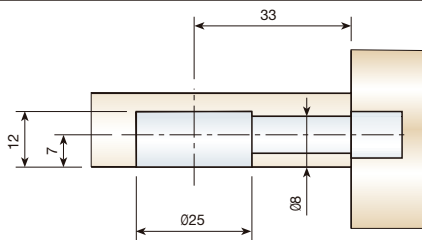

### TWIN BOLT.



ZINC-COATED 522.077.032 1.000

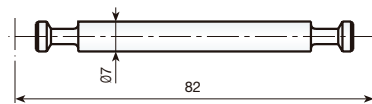
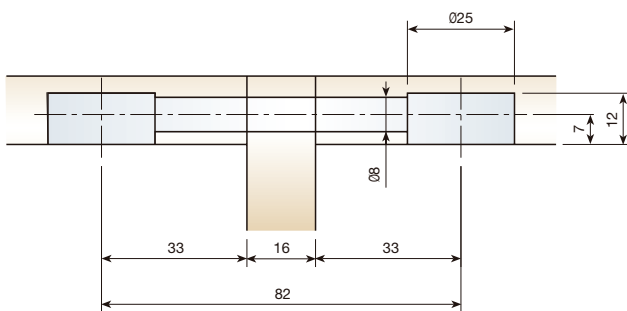

### TWIN ANGLE BOLT.



ZINC-COATED 522.100.036 1.000

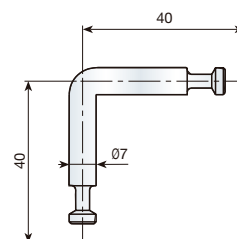
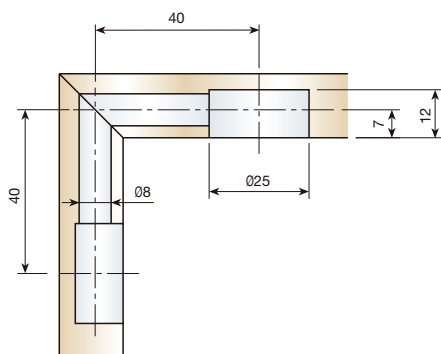

### 3 NUTS

#### STEEL WOOD-THREADED NUT, WITHOUT HEAD.

BICHROMATED					
L (MM.)	Ød(MM.)	ØD (MM.)	1/4"	M6	
10	8	10	947.510.056	947.810.054	2.500
12	8	10	947.512.053	947.812.051	2.000
14	8	10	947.514.050	947.814.055	2.000
18	8	10	947.518.051	947.818.056	2.000
22	8	10	947.522.052	947.822.050	2.000
10	9	12	947.610.053	947.910.051	2.000
12	9	12	947.612.050	947.912.055	2.000
14	9	12	947.614.054	947.914.052	2.000
16	9	12	947.616.051	947.616.051	2.000
18	9	12	947.618.055	947.918.053	2.000

  

L (MM.)	Ød(MM.)	ØD (MM.)	M8	
22	11	14	948.222.052	1.500

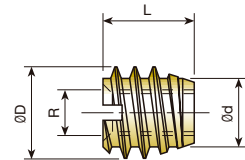

#### EXPANDING BRASS NUT.

M4			
944.805.105	2.000	OR 10.000	

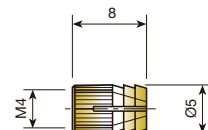

#### M6 SELF-EXPANDING BRASS NUT.

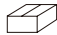
M6			
Ø8 x 12 MM.	944.112.105	5.000	

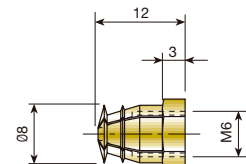

#### WING NUT

1/4"		M6	
BICHROMATED		948.913.055	2.000
ZINC-COATED	948.813.036		

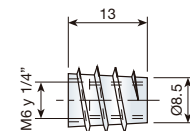

#### WING NUT WITH HEAD.

1/4"		M6	M8	
BICHROMATED		948.713.054	2.000	
ZINC-COATED	948.613.035	948.515.035		

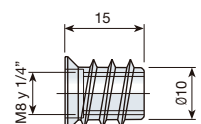
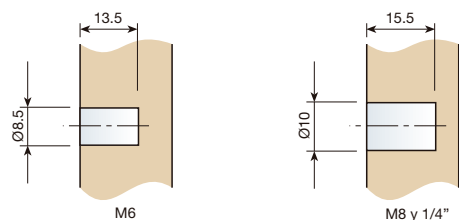
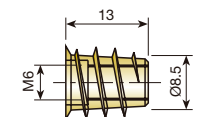

M4 NYLON KNOCK-IN NUT FOR Ø8.

				
NATURAL		937.004.106		2.000 OR 10.000
BROWN	RAL 8016	937.004.014		

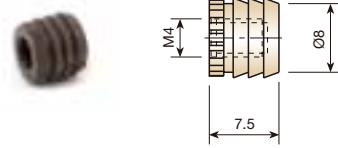

NYLON KNOCK-IN NUT FOR Ø10

R	M6	1/4"		
NATURAL	937.006.103	937.014.105		2.000 OR 10.000
BROWN	RAL 8016 937.006.011	937.014.013		
BLACK	RAL 9005 937.006.022	937.014.024		

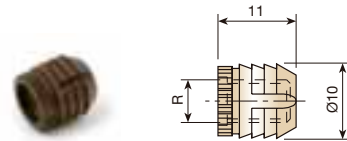

NYLON KNOCK-IN NUT FOR Ø11

R	M6	1/4"		
NATURAL	937.106.100	937.114.102		2.000 OR 10.000
BROWN	RAL 8016 937.106.015	937.114.010		

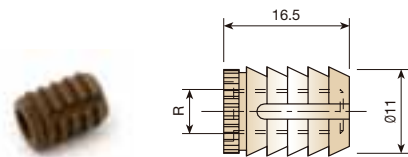

M6 NYLON KNOCK-IN NUT FOR Ø10, IN STRIPS.

				
NATURAL		937.406.105		4.800
BROWN	RAL 8016	937.406.013		
BLACK	RAL 9005	937.014.024		

EVERY BOX CONTAINS 200 STRIPS.  
THE STRIPS COME WITH 24 UNITS, AND THEY MAY BE PLACED MANUALLY OR BY MEANS OF A PNEUMATIC GUN WITH A CHARGER.

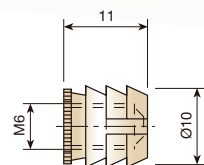

M6 STEEL RIBBED KNOCK-IN NUT.

L	16 MM.	18 MM.		
ZINC-COATED	938.716.100	938.718.104		1.000 OR 5.000

