

Ø25 snail cam

CAMS

1 CAMS AND COVERS.....		<i>pp.</i> 260
2 BOLTS.....	 261
3 NUTS	 262

1 CAMS AND COVERS

COVER Ø25 MM.

				
WHITE	RAL 9003	530.400.006		
BROWN	RAL 8016	530.400.010	2.000	
BLACK	RAL 9005	530.400.021		
NICKEL-PLATED		530.400.065	1.000	

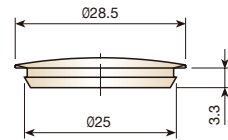

NARROW SNAIL CAM Ø25 MM.

				
ZINC-COATED		510.308.035	2.000	

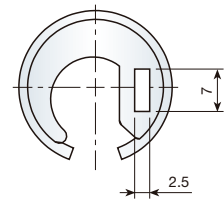
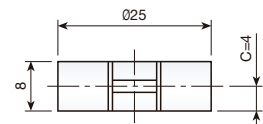

WIDESNAIL CAM Ø25 MM.

				
ZINC-COATED		510.211.030	1.000	

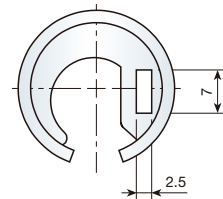
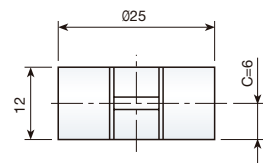

2 BOLTS

M6 EYE BOLT.

DRILLING DISTANCE 33MM.

ZINC-COATED

520.937.034

2.000

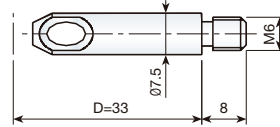
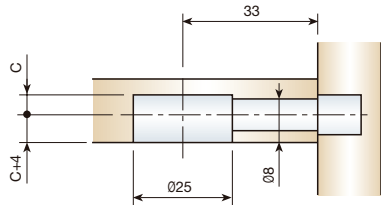

DOUBLE EYE BOLT.

ZINC-COATED

521.079.031

1.000

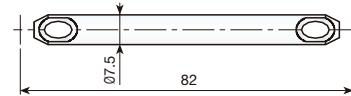
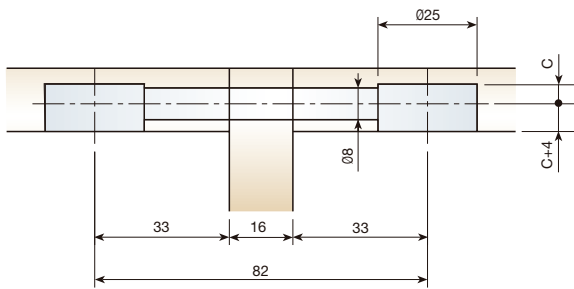

ANGLE DOUBLE EYE BOLT.

ZINC-COATED

521.100.031

1.000

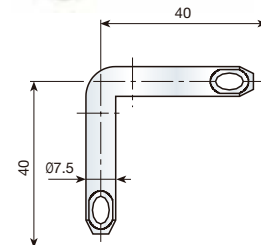
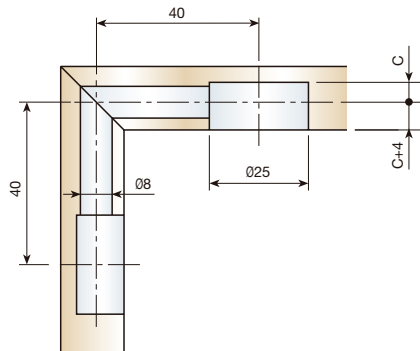

3 NUTS

STEEL WOOD-THREADED NUT, WITHOUT HEAD.

BICHROMATED					
L (MM.)	Ød(MM.)	ØD (MM.)	1/4"	M6	
10	8	10	947.510.056	947.810.054	2.500
12	8	10	947.512.053	947.812.051	2.000
14	8	10	947.514.050	947.814.055	2.000
18	8	10	947.518.051	947.818.056	2.000
22	8	10	947.522.052	947.822.050	2.000
10	9	12	947.610.053	947.910.051	2.000
12	9	12	947.612.050	947.912.055	2.000
14	9	12	947.614.054	947.914.052	2.000
16	9	12	947.616.051	947.616.051	2.000
18	9	12	947.618.055	947.918.053	2.000

L (MM.)	Ød(MM.)	ØD (MM.)	M8	
22	11	14	948.222.052	1.500

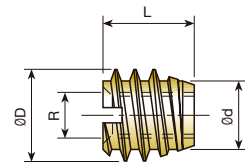

EXPANDING BRASS NUT.

M4			
944.805.105	2.000	OR 10.000	

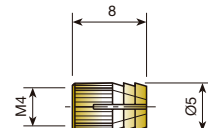

M6 SELF-EXPANDING BRASS NUT.

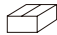
M6			
Ø8 x 12 MM.	944.112.105	5.000	

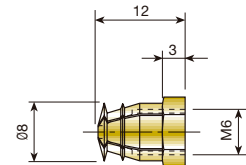

WING NUT.

1/4"		M6	
BICHROMATED	948.913.055	2.000	
ZINC-COATED	948.813.036		

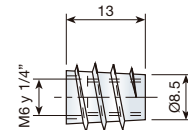

WING NUT WITH HEAD.

1/4"		M6	M8	
BICHROMATED	948.713.054	2.000		
ZINC-COATED	948.613.035		948.515.035	

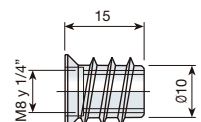
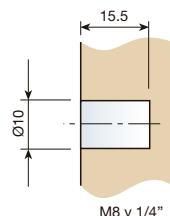
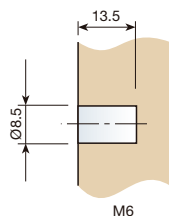
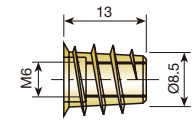

M4 NYLON KNOCK-IN NUT FOR Ø8.

				
NATURAL		937.004.106		2.000 OR 10.000
BROWN	RAL 8016	937.004.014		

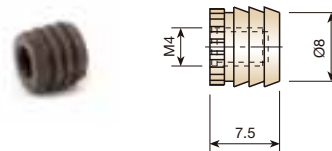

NYLON KNOCK-IN NUT FOR Ø10.

R	M6	1/4"		
NATURAL	937.006.103	937.014.105		2.000 OR 10.000
BROWN	RAL 8016 937.006.011	937.014.013		
BLACK	RAL 9005 937.006.022	937.014.024		

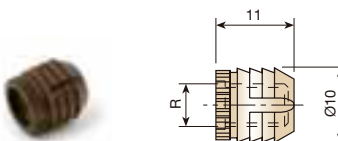

NYLON KNOCK-IN NUT FOR Ø11

R	M6	1/4"		
NATURAL	937.106.100	937.114.102		2.000 OR 10.000
BROWN	RAL 8016 937.106.015	937.114.010		

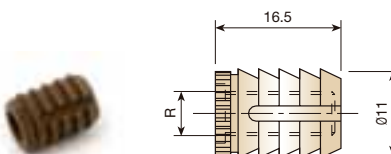

M6 NYLON KNOCK-IN NUT FOR Ø10, IN STRIPS.

				
NATURAL		937.406.105		4.800
BROWN	RAL 8016	937.406.013		
BLACK	RAL 9005	937.014.024		

EVERY BOX CONTAINS 200 STRIPS.
THE STRIPS COME WITH 24 UNITS, AND THEY MAY BE PLACED MANUALLY OR BY MEANS OF A NEUMATIC GUN WITH A CHARGER.

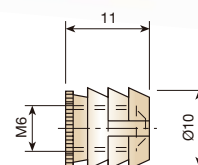

M6 STEEL RIBBED KNOCK-IN NUT.

L	16 MM.	18 MM.		
ZINC-COATED	938.716.100	938.718.104		1.000 OR 5.000

