

A SOLUTION FOR HEAVY LOADS BUT WITH MINIMUM DRILLING REQUIREMENTS. THE Ø25 SPIRAL CAM ELIMINATES ANY POSSIBLE LOOSENING DUE TO VIBRATION. FOR 15 MM.-THICK BOARDS AND UPWARDS.

Ø25 Spiral cam

Ø25 Spiral cam

CAM

1 CAMS AND COVERS		<i>pp.</i> 267
2 BOLTS	 268
3 NUTS	 269
4 ASSEMBLY 271

1 CAMS AND COVERS

Ø25 MM. SPIRAL CAM.

			
NICKEL		511.525.066	
ZINC-PLATED		511.525.033	500

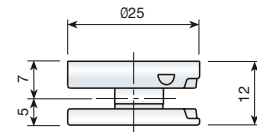
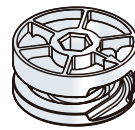

COVER CAP.

			
	BOARD THICKNESS	COVER	
NICKEL	14 TO 20MM	A 530.225.065	
WHITE	RAL 9003 >20MM	B 530.400.006	
BROWN	RAL 8016 >20MM	B 530.400.010	1.000
BLACK	RAL 9005 >20MM	B 530.400.021	
NICKEL	>20MM	B 530.400.065	

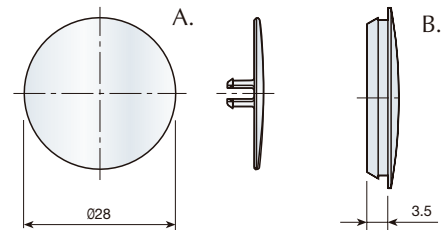
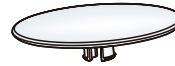

2 BOLTS

CONNECTING ROD

ZINC-PLATED	520.133.036	500
-------------	-------------	-----

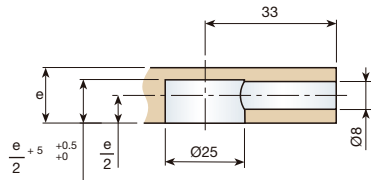
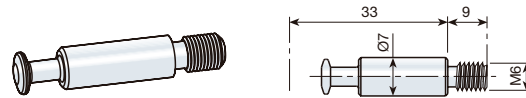

DOUBLE CONNECTING ROD

ZINC-PLATED	528.133.034	500
-------------	-------------	-----

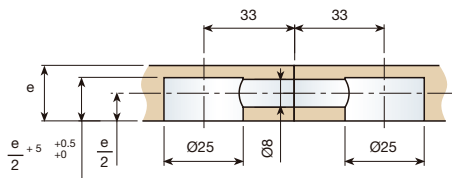
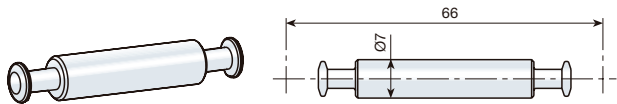

DOUBLE CONNECTING ROD FOR MIDDLE PANEL

ZINC-PLATED	528.233.031	500
-------------	-------------	-----

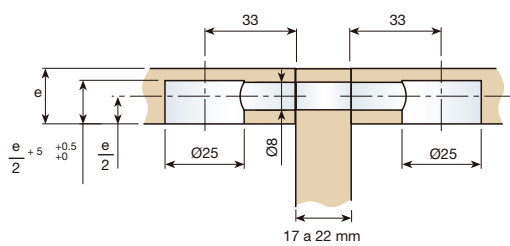
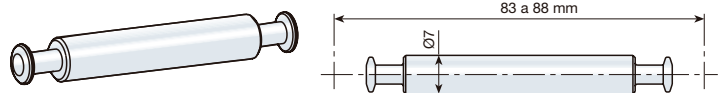

90° CONNECTING ROD

ZINC-PLATED	528.333.035	500
-------------	-------------	-----

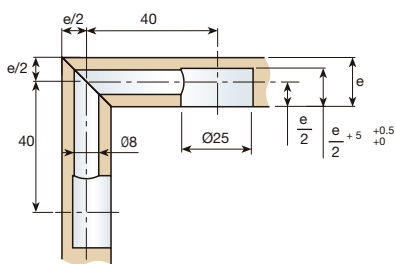
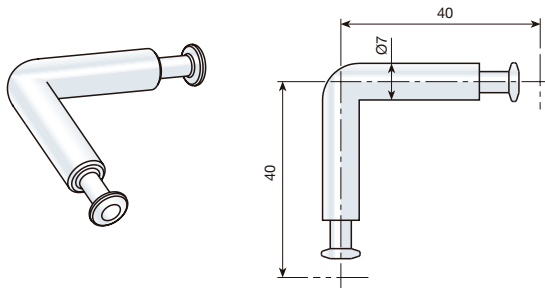

3 NUTS

STEEL WOOD THREADED NUT WITHOUT HEAD.

BICHROMATED					
L (MM.)	Ød(MM.)	ØD (MM.)	1/4"	M6	
10	8	10	947.510.056	947.810.054	2.500
12	8	10	947.512.053	947.812.051	2.000
14	8	10	947.514.050	947.814.055	2.000
18	8	10	947.518.051	947.818.056	2.000
22	8	10	947.522.052	947.822.050	2.000
10	9	12	947.610.053	947.910.051	2.000
12	9	12	947.612.050	947.912.055	2.000
14	9	12	947.614.054	947.914.052	2.000
16	9	12	947.616.051	947.616.051	2.000
18	9	12	947.618.055	947.918.053	2.000

L (MM.)	Ød(MM.)	ØD (MM.)	M8	
22	11	14	948.222.052	1.500

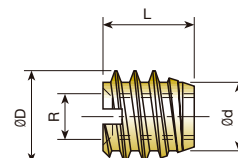

EXPANDING BRASS NUT

M4			
944.805.105	2.000	OR 10.000	

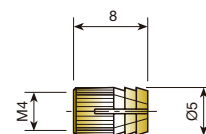

M6 SELF-EXPANDING BRASS NUT.

M6			
8 Øx 12 MM.	944.112.105	5.000	

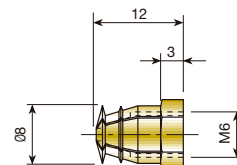

WING NUT.

1/4"		M6	
BICHROMATED		948.913.055	2.000
ZINC-PLATED	948.813.036		

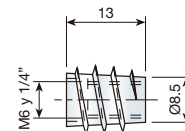

WING NUT WITH HEAD.

1/4"		M6	M8	
BICHROMATED		948.713.054		2.000
ZINC-PLATED	948.613.035		948.515.035	

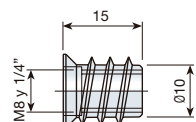
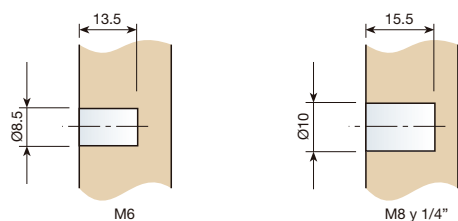
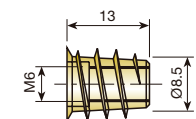

3 NUTS

M4 NYLON KNOCK-IN NUT FOR Ø8.

			
NATURAL		937.004.106	2.000 OR 10.000
BROWN	RAL 8016	937.004.014	

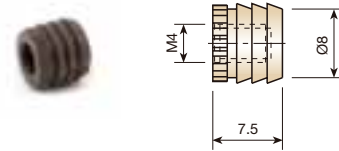

NYLON KNOCK-IN NUT FOR Ø10.

R	M6	1/4"	
NATURAL	937.006.103	937.014.105	
BROWN	RAL 8016	937.006.011	2.000 OR 10.000
BLACK	RAL 9005	937.006.022	937.014.024

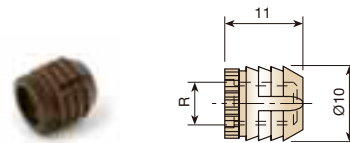

NYLON KNOCK-IN NUT FOR Ø11.

R	M6	1/4"	
NATURAL	937.106.100	937.114.102	2.000 OR 10.000
BROWN	RAL 8016	937.106.015	937.114.010

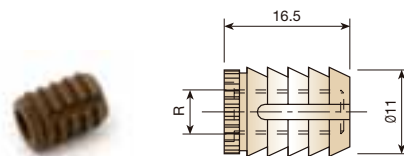

M6 NYLON KNOCK-IN NUT FOR Ø10, IN STRIPS.

			
NATURAL		937.406.105	
BROWN	RAL 8016	937.406.013	4.800
BLACK	RAL 9005	937.014.024	

EVERY BOX CONTAINS 200 STRIPS.
THE STRIPS COME WITH 24 UNITS, AND THEY MAY BE PLACED MANUALLY OR BY MEANS OF A PNEUMATIC GUN WITH A CHARGER.

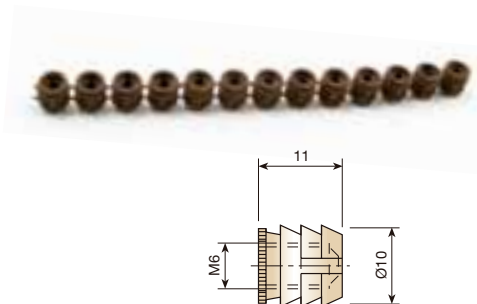

M6 STEEL RIBBED KNOCK-IN NUT.

L	16 MM.	18 MM.	
ZINC-PLATED	938.716.100	938.718.104	1.000 OR 5.000

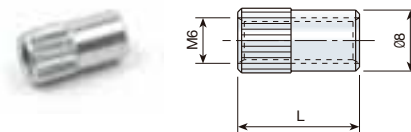

4 ASSEMBLY

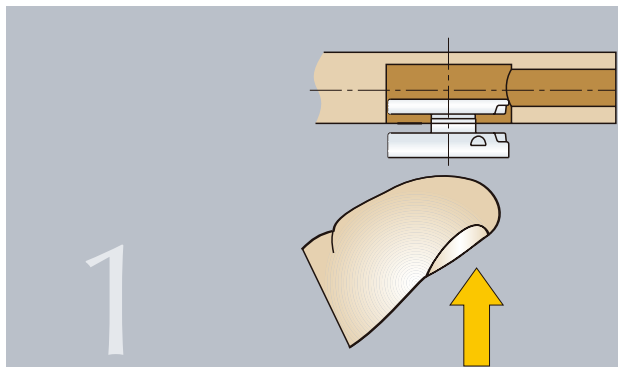

MANUALLY INSERT THE SPIRAL CAM IN THE CAVITY IN THE SHELF OR BOARD.

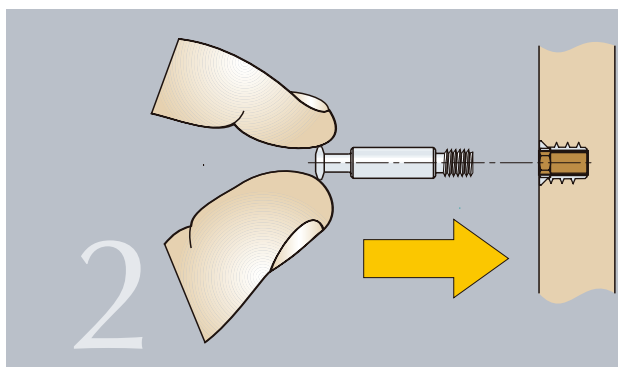

INSERT THE NUT IN THE SIDE CAVITY AND THEN SCREW THE BOLT INTO THE NUT.

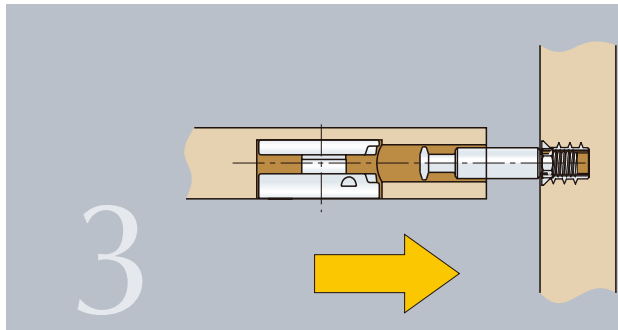

ALIGN THE SPIRAL CAM WITH THE BOLT.

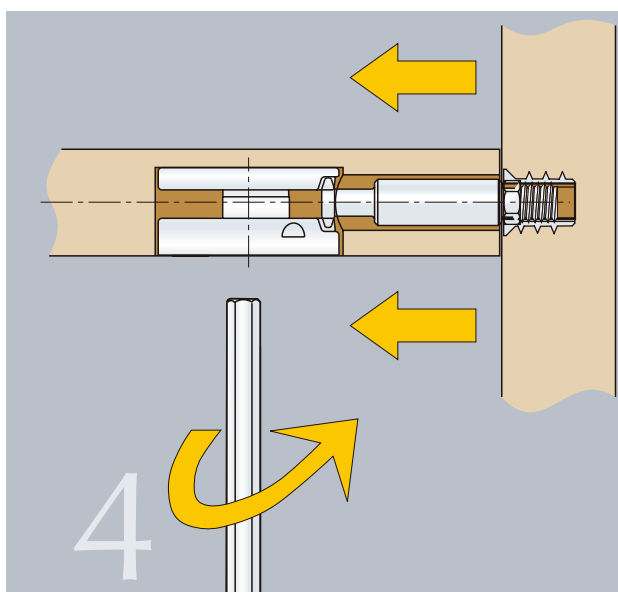

WHEN THE CAM IS TURNED, THE BOLT WILL MOVE TOWARDS THE CAM AND THE SIDE AND THE CAM WILL BE JOINED, THUS OBTAINING A STRONG AND EFFECTIVE CONNECTION.

TO DISMANTLE THE SHELF, FOLLOW THE SAME STEPS BACKWARDS.