

# Assemblies for work surfaces

## JOINING ASSEMBLIES

### 1 HALF MOON JOINING BOLT

THIS INVISIBLE JOINING BOLT ALLOWS THE UNION OF WORKTOPS, PANELS AND MITRED PROFILES IN A QUICK AND SAFE MANNER.

#### HALF MOON JOINING BOLT

L (MM.)		
40	521.604.031	250
80	521.608.032	
120	521.612.033	

EACH ASSEMBLY FITTING CONSIST OF 2 BODIES, 1 BOLT AND 1 NUT.

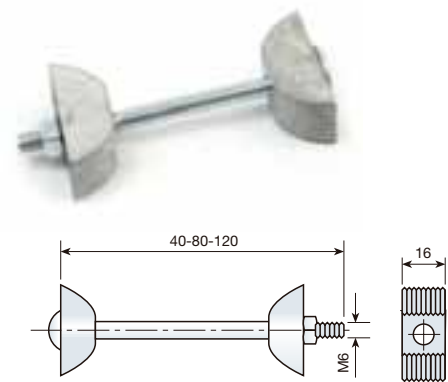

#### ASSEMBLY METHOD

DRILL A Ø35MM BY 20MM DEEP HOLE A DISTANCE EQUIVALENT TO A FROM EACH EDGE TO BE JOINED TOGETHER. IN LINE WITH THE CENTRE OF THE DRILL HOLES, JOIN TOGETHER VIA A 15MM DEEP X 15MM WIDE GROOVE. BY TIGHTENING THE NUT, THE HALF MOON BODIES FORCE THE 2 JOINT EDGES TOGETHER.

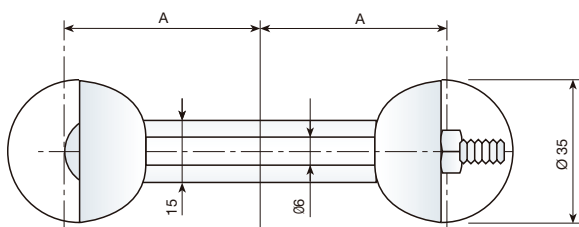

SCREW	DRILLING DISTANCE "A"
40 MM.	DE 17 A 20 MM.
80 MM.	DE 33 A 40 MM.
120 MM.	DE 53 A 60 MM.

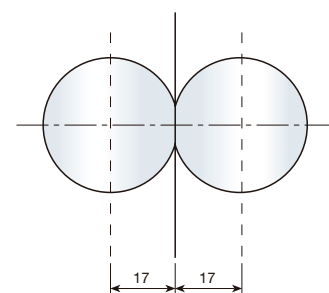
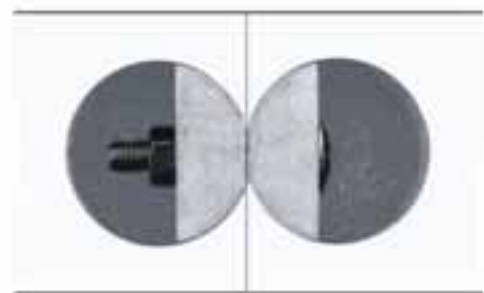
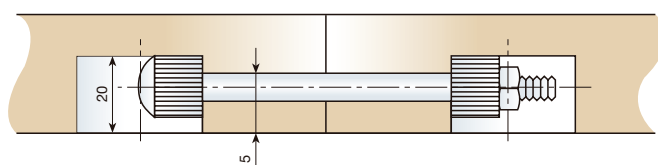

WITH THE CENTRE AT 17MM THERE IS NO NEED FOR THE GROOVE.

## 2 ASSEMBLIES FOR WORK SURFACES

### ASSEMBLY TO JOIN WORK SURFACES.

L (MM.)	ZINC-PLATED	
65	519.306.034	
100	519.310.035	200
150	519.315.031	

EACH REFERENCE IS DELIVERED PRE-MOUNTED.

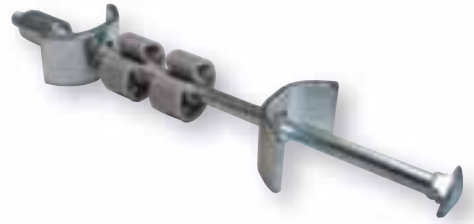

### MEASUREMENTS.

L (MM.)	A (MIN.)	A (MÁX.)
65	32	42
100	50	60
150	75	85

