



"SCARPI-4"

"SCARPI-4" CABINET HANGER

HEAVY DUTY CABINET HANGER:

65 KG PER HANGER ACCORDING TO DIN 68840 (TESTED TO HOLD 260 KG. PER SET).

IT ALLOWS THREE INDEPENDENT ADJUSTMENTS, EASILY ACCESSIBLE FROM THE FRONT SIDE.

CONCEALED BY AN EXTRA THIN COVER IN DIFFERENT COLOURS.

AVAILABLE FOR KNOCK-IN OR SCREW-ON ASSEMBLY.

THE HANGER IS ENTIRELY MADE OF STEEL AND THEREFORE IT CAN BE RECYCLED WITHOUT ANY PROBLEMS.

		<i>pp.</i>
1	"SCARPI-4"	324
■	"SCARPI-4" CABINET HANGER	324
■	ACCESSORIES	325

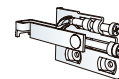

1 "SCARPI-4"

"SCARPI-4" CABINET HANGER

HEAVY DUTY CABINET HANGER: 65 KG PER HANGER ACCORDING TO DIN 68840 (TESTED TO HOLD 260 KG. PER SET). IT ALLOWS THREE INDEPENDENT ADJUSTMENTS, EASILY ACCESSIBLE FROM THE FRONT SIDE. CONCEALED BY AN EXTRA THIN COVER IN DIFFERENT COLOURS. AVAILABLE FOR KNOCK-IN OR SCREW-ON ASSEMBLY. THE HANGER IS ENTIRELY MADE OF STEEL AND THEREFORE IT CAN BE RECYCLED WITHOUT ANY PROBLEMS.

EURO-SCREW HANGER.

	LEFT	RIGHT	
ZINC-PLATED	625.000.036	625.100.033	200

EURO-SCREW SCREWS INCLUDED.

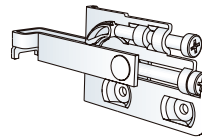
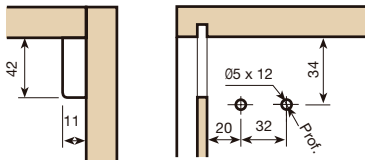

3 ADJUSTMENTS	
HEIGHT	13 MM
FRONT	17 MM
SIDE	8 MM

KNOCK-IN HANGER.

	LEFT	RIGHT	
ZINC-PLATED	625.200.030	625.300.034	200

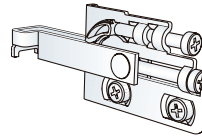
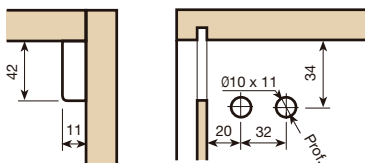

3 ADJUSTMENTS	
HEIGHT	13 MM
FRONT	17 MM
SIDE	8 MM

SCREW-ON HANGER.

	LEFT	RIGHT	
ZINC-PLATED	625.400.031	625.500.035	200

Ø5 x 16 SCREWS INCLUDED.

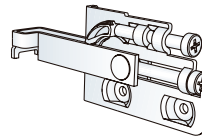
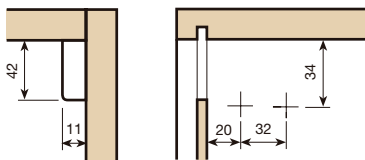

3 ADJUSTMENTS	
HEIGHT	13 MM
FRONT	17 MM
SIDE	8 MM

COVER.

	LEFT	RIGHT	
WHITE RAL 9001	639.000.003	639.100.000	400
BROWN RAL 8016	639.000.014	639.100.011	
GREY RAL 9006	639.000.143	639.100.140	
OAK RAL 1002	639.000.191	639.100.195	
NICKEL	639.000.062	639.100.066	200

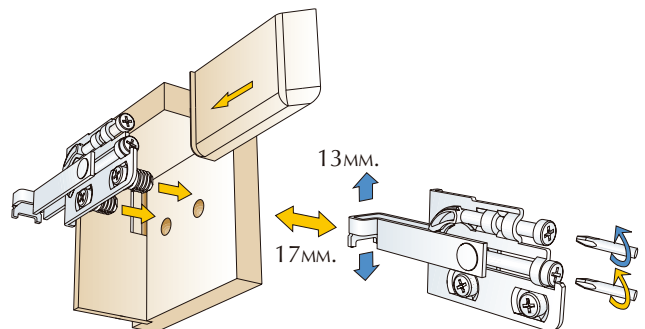

ACCESSORIES

BAG OF ACCESSORIES.

	
620.400.105	200

PACKED IN BOXES CONTAINING 200 BAGS. EACH BAG CONTAINING 1 DOUBLE WALL MOUNTING PLATE (B), 4 SCREWS Ø4,5 x 35 (C), AND 4 PLASTIC WALL PLUGS Ø6 x 30 (D).

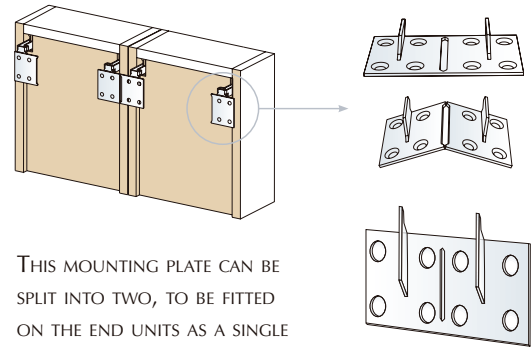

THIS MOUNTING PLATE CAN BE SPLIT INTO TWO, TO BE FITTED ON THE END UNITS AS A SINGLE MOUNTING PLATE.

DOUBLE WALL MOUNTING PLATE.

		
ZINC-PLATED	623.000.033	200

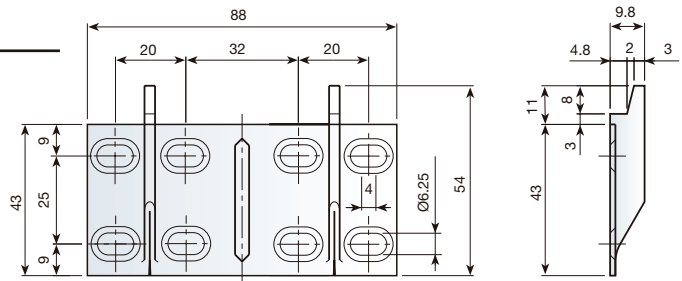

SCREWS Ø4,5 x 35.

		
ZINC-PLATED	982.435.031	5.000



PLASTIC WALL PLUGS Ø6 x 30.

		
NATURAL	662.130.302	1.000 OR 10.000

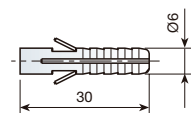

PLASTIC WALL PLUGS Ø8 x 40.

		
NATURAL	662.240.106	1.000 OR 10.000

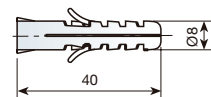

SQUARE SCREW HOOK.

		
ZINC-PLATED	661.200.035	1.000

