

# Fittings for coplanar doors

FOR CABINETS AND CUPBOARDS.  
FOR AUXILIARY UNITS

pp.

1 "MAGIC" .....	628
-----------------	-----

# 1 "MAGIC"

## SET OF UPPER AND LOWER TRACK PROFILES.

LENGTH	2.200	3.000	
ANODIZED SILVER	706.322.503	706.330.505	1

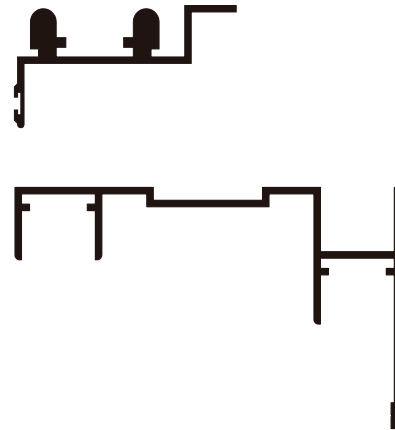

## SET OF FITTINGS.

LENGTH OF DOOR	700-800	900-1.000	
2 DOORS	705.270.101	705.290.106	1
3 DOORS	705.370.105	705.390.103	

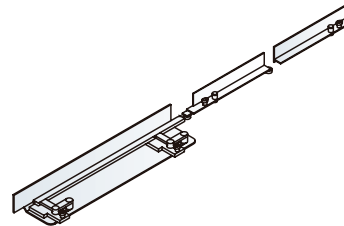

## ALUMINIUM DOOR.

		
ANODIZED MATT SILVER	147.900.513	1

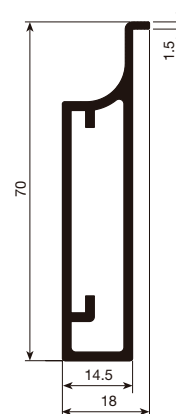

■ TECHNICAL DATA

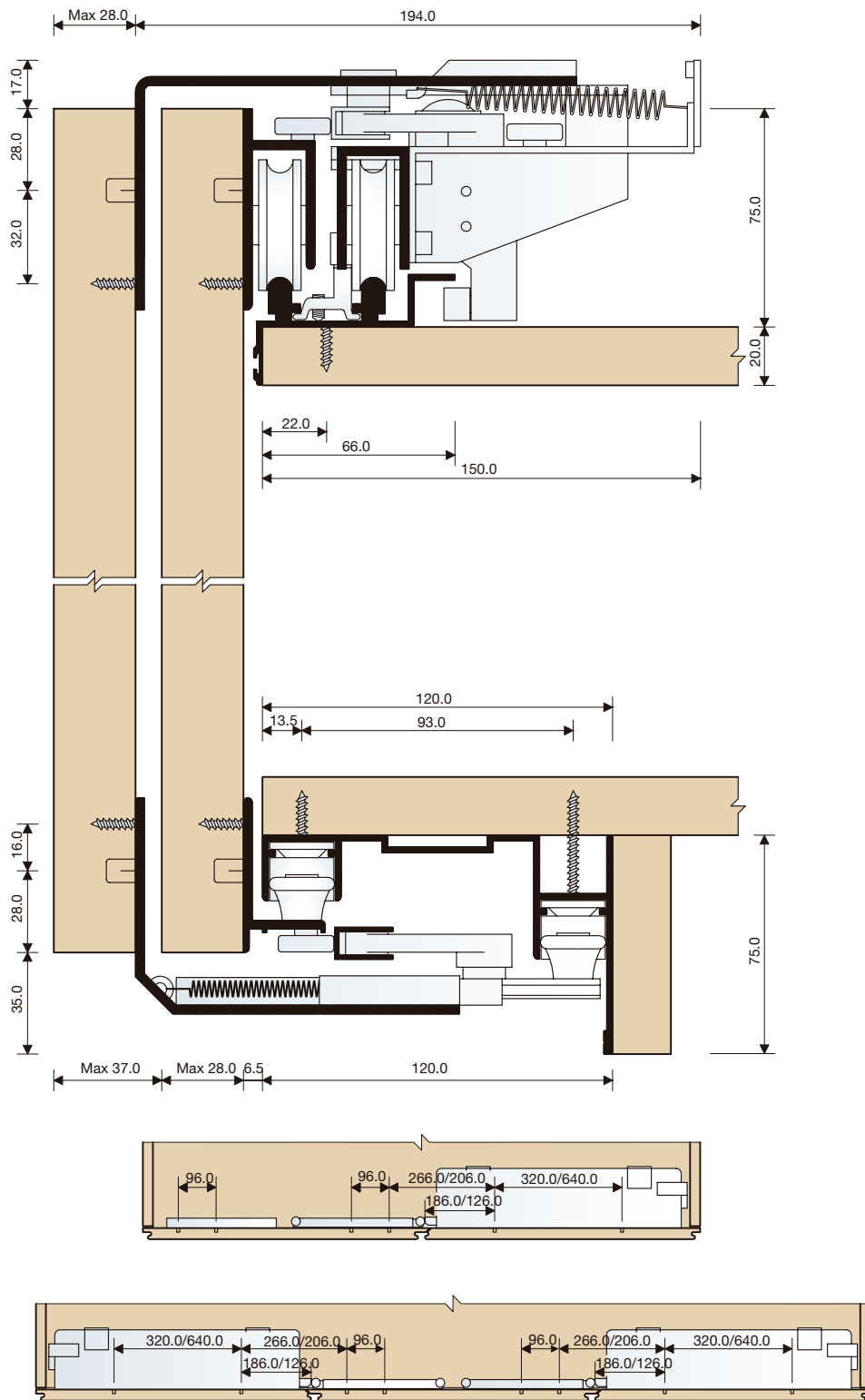

■ TECHNICAL DATA

Assembly

