

Straighteners

THIS FITTING HELPS TO CORRECT ANY POSSIBLE DOOR WARPING, AND TO PREVENT IT FROM RE-APPEARING. IT IS RECOMMENDED FOR USE WITH DOOR THICKNESS OF 16MM AND ABOVE, AND FOR HEIGHTS UP TO 2,600MM.

	<i>pp.</i>
1 STRAIGHTENER 1.....	652
<hr/>	
2 STRAIGHTENER 3.....	654

1 STRAIGHTENERS 1

THIS FITTING HELPS TO CORRECT ANY POSSIBLE DOOR WARPING, AND TO PREVENT IT FROM RE-APPEARING. IT IS RECOMMENDED FOR USE WITH DOOR THICKNESS OF 16 MM AND ABOVE, AND FOR HEIGHTS UP TO 2,600 MM.

STRAIGHTENER SET.

		
NICKEL-PLATED	754.000.063	50

IN BOXES OF 50 SETS.

ROD.

L = DISTANCE BETWEEN CENTRES	NICKEL-PLATED	
960 MM = (32 x 30)	716.009.066	
1.152 MM = (32 x 36)	716.011.063	
1.344 MM = (32 x 30)	716.013.060	
1.536 MM = (32 x 42)	716.015.064	
1.728 MM = (32 x 54)	716.017.061	25
1.920 MM = (32 x 60)	716.019.065	
2.112 MM = (32 x 66)	716.021.062	
2.304 MM = (32 x 72)	716.023.066	
2.496 MM = (32 x 78)	716.024.061	

SPECIAL SIZES TO ORDER.



MEASUREMENTS FOR MACHINING ON THE DOOR

DRILLING HOLES ON THE BODY

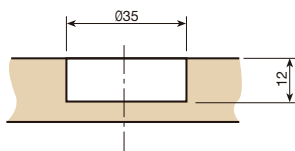

SLOT FOR ROD

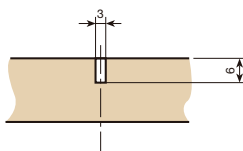

NOTE

2 STRAIGHTENERS PER DOOR ARE RECOMMENDED.

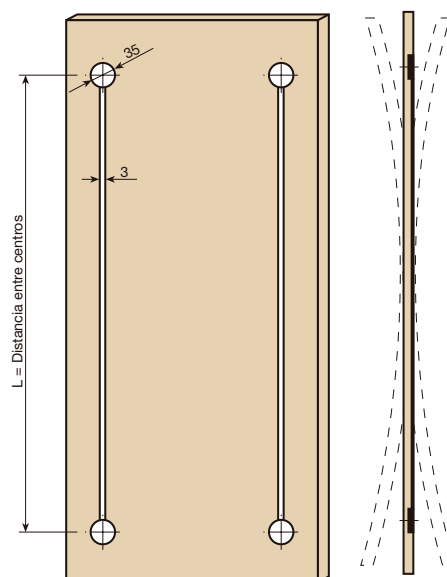

Assembly

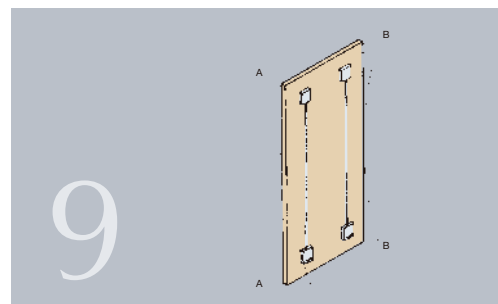
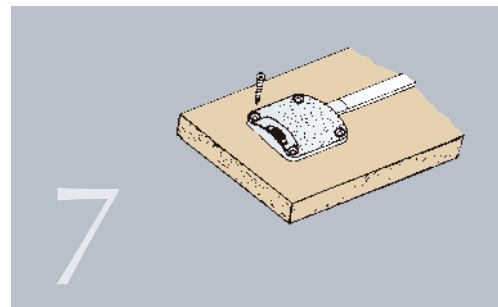
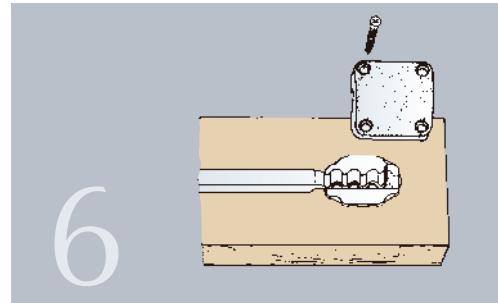
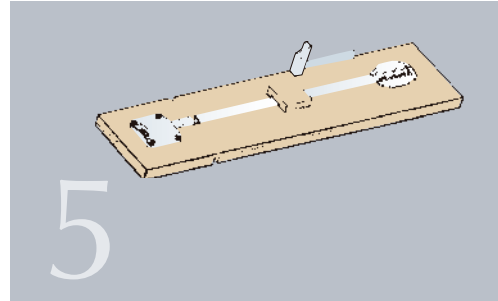
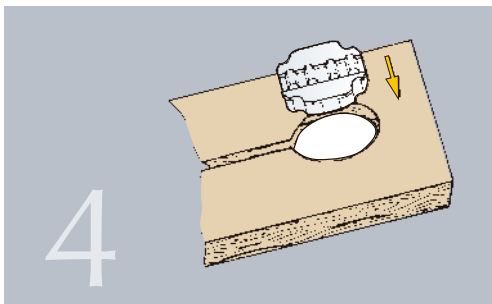
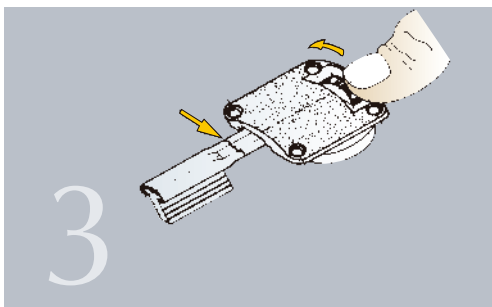
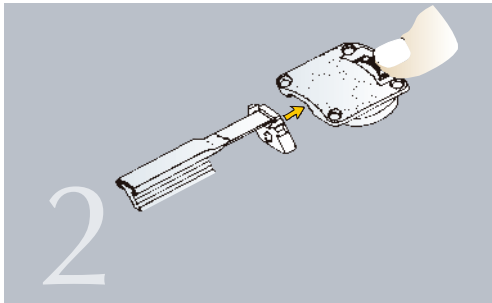
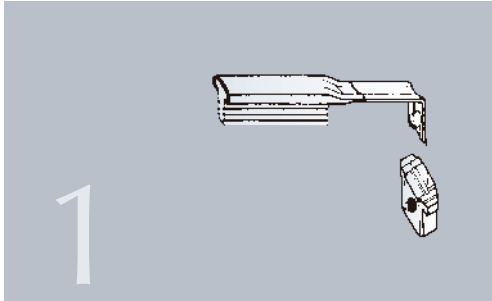

2 STRAIGHTENERS 3

THIS FITTING HELPS TO CORRECT ANY POSSIBLE DOOR WARPING, AND TO PREVENT IT FROM RE-APPEARING. IT IS RECOMMENDED FOR USE WITH DOOR THICKNESS OF 16MM AND ABOVE, AND FOR HEIGHTS UP TO 2,600MM.

STRAIGHTENER SET 3.

DIST. BETWEEN CENTRES L	THREADED STUD BOLT L	COVER CAP L	SET REF.	
1.600 MM (32x50)	1.648 MM	1.540 MM	754.516.103	50
1.824 MM (32x57)	1.872 MM	1.764 MM	754.518.100	
1.920 MM (32x60)	1.968 MM	1.860 MM	754.519.102	
2.304 MM (32x72)	2.352 MM	2.244 MM	754.523.103	

EACH SET HAS 1 UPPER BODY, 1 LOWER BODY, 38 SCREWS, 2 NUTS, 1 THREADED STUD BOLT AND 1 COVER CAP PROFILE. SPECIAL SIZES TO ORDER.

DIST. BETWEEN CENTRES	A
1.600 MM	20
1.824 MM	57
1.920 MM	30
2.304 MM	72

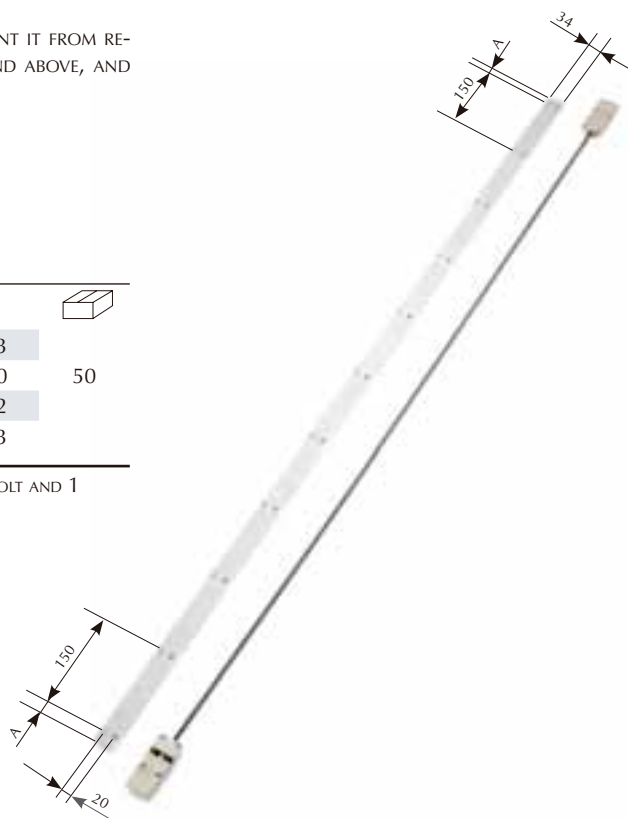

MEASUREMENTS FOR MACHINING ON THE DOOR

DRILLING HOLES ON THE BODY

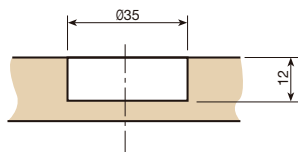

SLOT FOR COVER CAP

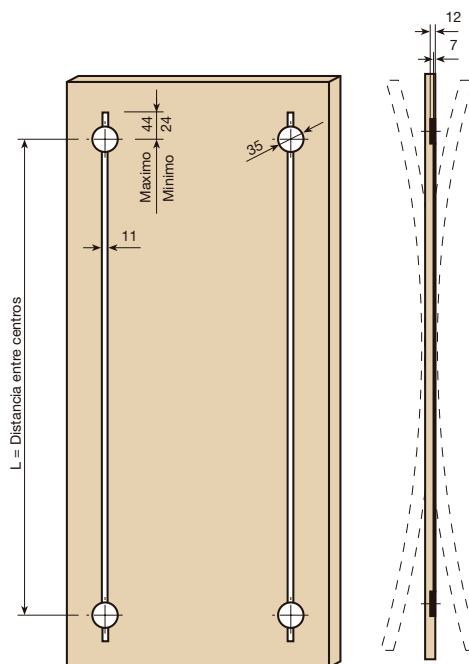
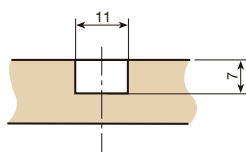

NOTE

2 STRAIGHTENERS PER DOOR ARE RECOMMENDED.