

# Fittings for interior doors

INTERIOR SLIDING DOOR SYSTEM, "OVER" MODEL:  
SUITABLE FOR BOTH ALUMINIUM AND WOODEN DOORS.  
TWO ASSEMBLY METHODS. THE UNMACHINED METHOD MINIMISES THE DISTANCE FROM THE DOOR TO THE RAIL.

	<i>PP.</i>
<b>1</b> "OVER" .....	638

# 1 "OVER"

## UPPER TRACK PROFILE.

	CUT TO MEASURE	6M. BARS	
ANODIZ. SILVER	706.600.101	706.660.102	4



## SINGLE UPPER TRACK PROFILE.

	CUT TO MEASURE	
ANODIZ. SILVER	709.310.103	1

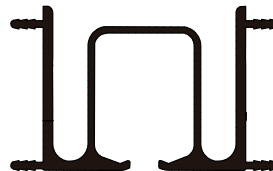

## DOUBLE UPPER TRACK PROFILE.

	CUT TO MEASURE	
ANODIZ. SILVER	709.320.102	1



## SET OF FITTINGS FOR A DOOR.

	SINGLE	DOUBLE	
UPPER FIXING	705.403.101	705.401.104	10
SIDE FIXING		705.402.106	

IT HAS TWO UPPER ROLLERS, TWO BRAKES AND ONE LOWER GUIDE RAIL. FOR 10 DOORS.

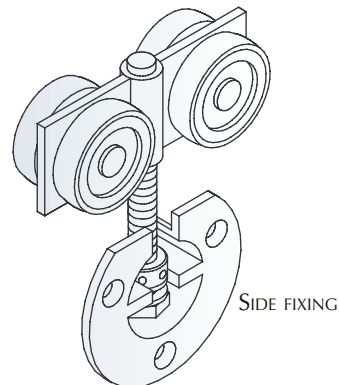
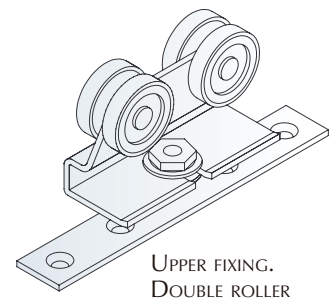
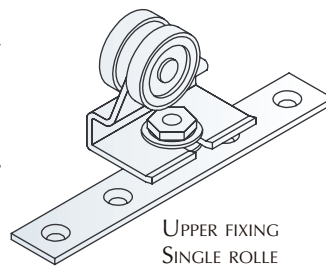
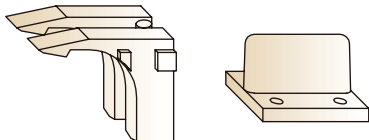

## Assembly

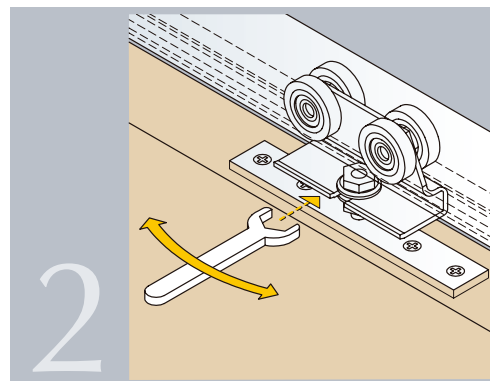
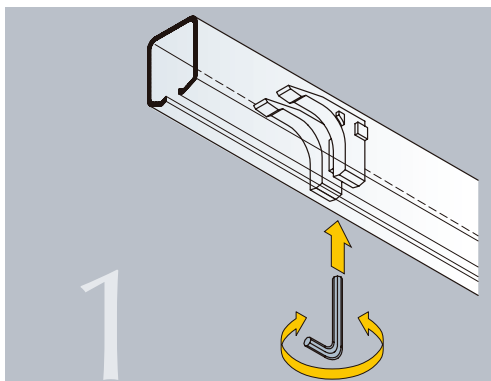

■ TECHNICAL DATA

ROLLER FOR UNMACHINED DOOR.

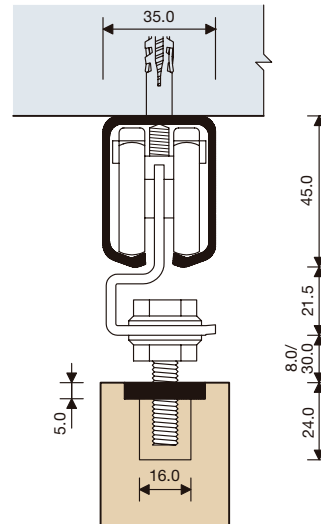
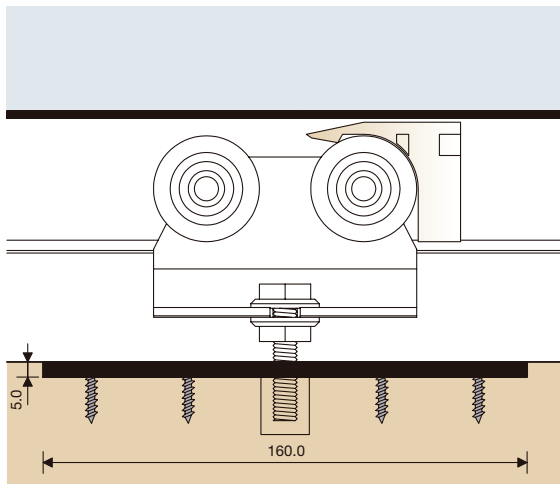

ROLLER FOR UNMACHINED DOOR.

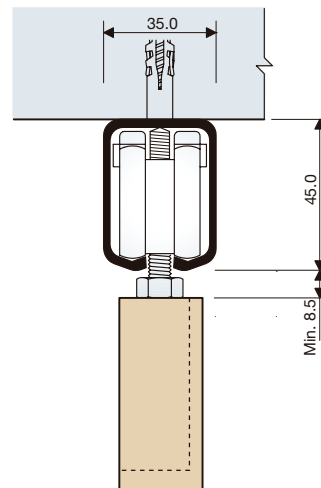
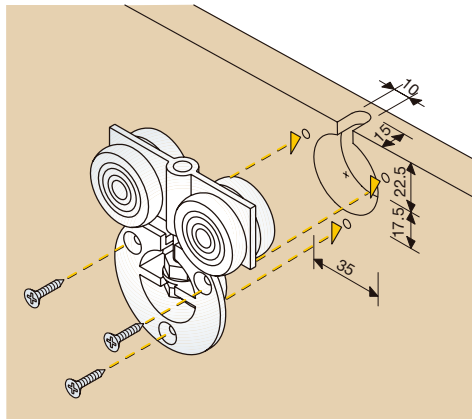

LOWER PART

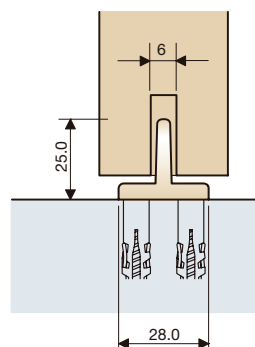
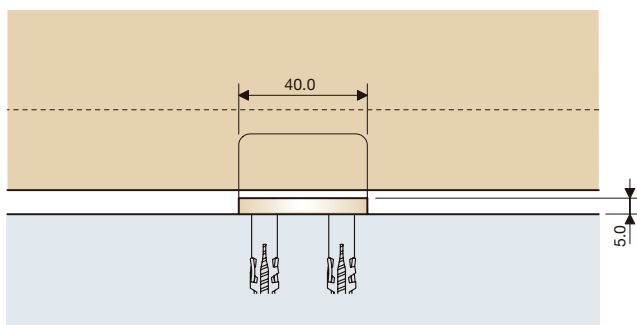

■ TECHNICAL DATA

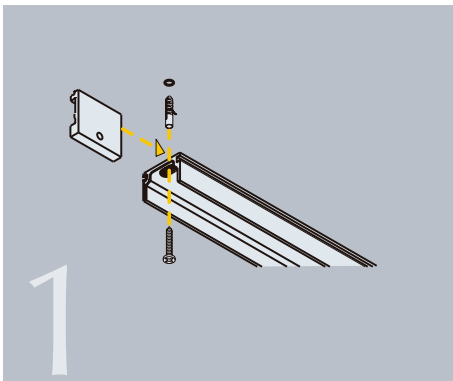

FIX THE SUPPORTING TRACK PROFILE TO THE CEILING AND INSERT THE RAIL'S SAFETY PLATE.

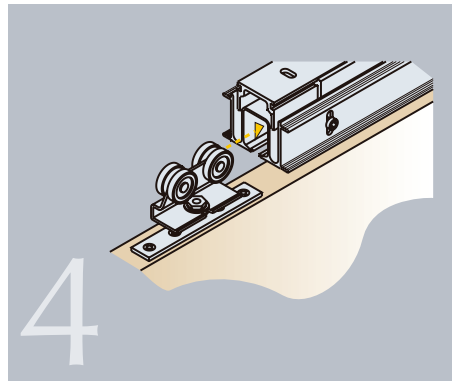

COUPLE THE DOOR TO THE ROLLERS INSERTED INTO THE RAILS AND ADJUST THE HEIGHT.

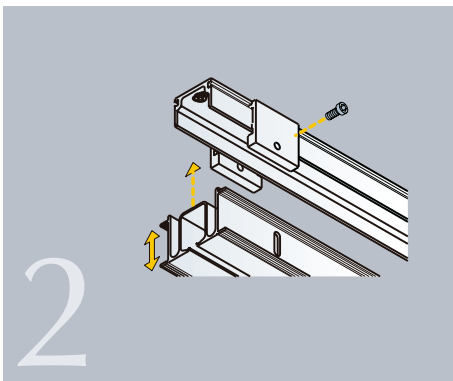

FIX THE RAIL TO THE SAFETY PLATE AND ADJUST THE HEIGHT.

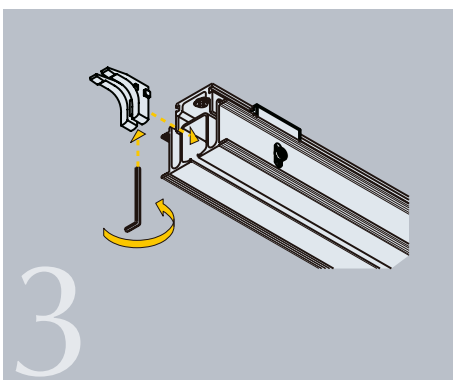
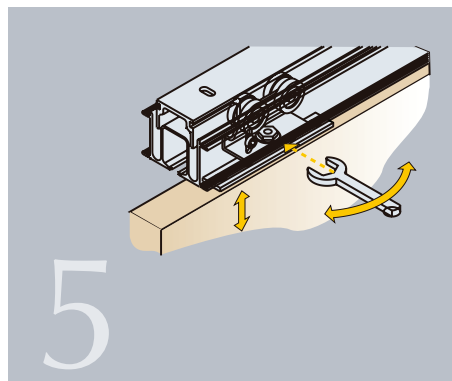

INSERT THE STOP AND BLOCK. SLIDING DOORS.

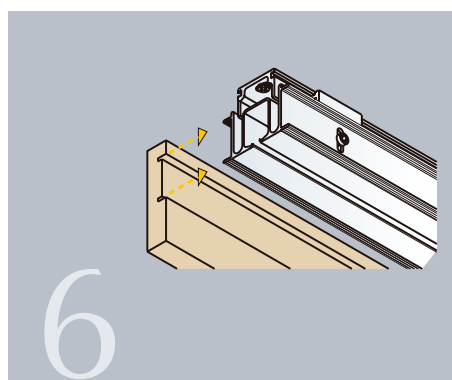

INSERT THE WOODEN COVER OVER THE RAIL.

■ TECHNICAL DATA

